

SUSTAINABLE



Valley



COLLECTION

Overlooking the meandering valley that naturally descends from the foothills of the Sierra de Mijas mountains, you will find this spectacular project...

Valley Collection



01 Higueron Resort

*H*iguerón Resort was born more than 30 years ago with a clear mission: to create spaces where people could feel safe, comfortable, happy and satisfied. We have consolidated this idea over the years by adding exclusivity to all our projects.

For this reason, the Platinum card was introduced to our residents, giving them the opportunity to enjoy our facilities, which are designed to meet their most demanding needs. With the Platinum card, our customers have access for a full year to our unique Sport Club area, and will be able to immerse themselves in the wellness of the Spa. They can also enjoy the VIP area at The Beach Club Higueron, located along the beach to dig into the good weather of the Costa del Sol.

Buying in Higueron Resort guarantees the best quality in your home, monitoring of your needs, security services, latest technology and carefully selected finishes with our thoughts on the highest energy efficiency and the environment.

Each of our projects has a privileged location with extraordinary views, carefully chosen and designed with extensive green areas landscaped with native vegetation according to our Mediterranean climate.

Higuerón Resort offers projects from the sea to the mountains based on our values of *sustainability, vanguard, trust and reliability*.



02 Higueron Spa



*E*nter a secret retreat: Higueron Spa invites you to worship the body and spirit, in an atmosphere of calmness and tranquillity.

Time will elapse between its different treatments and natural rituals to enjoy unforgettable sensations.



03 Higueron Sport Club



*A*n exclusive environment created around a perfect combination of outdoor and indoor facilities.

At your disposal a unique sport experience.





The Beach Club
Higueron

It is time to feel the Mediterranean at your feet, on the beachfront at Higuerón Beach Club, the only private beach club in Málaga.

You will have access to an exclusive privileged area where you can reconnect and enjoy the sound of the waves, the sand and the sun.

Higuerón
Yachts

Discover Higuerón Yachts, a unique experience sailing through the Mediterranean Sea that is at your disposal whenever you like.



Origin of
the *natural*
space.

Higueron Hotel 5* is a commitment to art, culture and gastronomy.

A place to feel the essence of Andalusia.

Gastronomy
also becomes an art.



Ten restaurants will take you through an unimaginable journey around the world. Highlighting SOLLO, led by Diego Gallegos, a caviar expert awarded with both a Michelin and green star.



Location

Valley Collection is located in Higuera Valley.

A 3 minute walk from Higuera Resort where you will find our exclusive Sport Club and Spa facilities, as well as restaurants, the train station or the shopping centre.

Valley Collection is located in Fuengirola, a sunny corner of the Mediterranean that allows you to enjoy the beautiful Andalusian landscape.

Environment

Surrounded by extensive green areas where you can enjoy the greatest relaxation.

The most unique hiking trails have never been closer.

10 minutes away from the Carvajal Beach, distinguished by its calm waters.

Enjoy your home in a familiar and relaxed environment that will allow you to lose yourself in the purest form of nature.

Breeam and Well *excellence.*



BREEAM® ES

Valley Collection is committed to promoting innovation and energy efficiency through new building systems, integrating design with technology.

Therefore, we have BREEAM and WELL sustainable certificates supporting your well-being.

BREEAM assesses responsible building practices during the development of a project, ensuring that the construction's impact is kept to a minimum. It also enables the design, planning and delivery of accessible, functional and participatory architecture.

The WELL™ building standard is a science-based rating system for measuring, certifying and monitoring the characteristics of a property that have an impact on people's health and well-being.

Energy

We believe in the construction of buildings that minimize operational energy consumption through proper design, thus reducing CO2 emissions.

RENEWABLE ENERGY: The housing units generate up to 20% of the energy they need through renewable energy installations such as AEROTHERMY

THERMAL INSULATION: The facade of the building is adapted to the orientation of the building and the climate zone in which it is located, minimizing heating requirements by up to 60%.

EFFICIENT LIGHTING: The exterior and common areas lighting fixtures have been selected because of their low consumption and high luminous efficiency.

INDOOR AIR QUALITY: All houses are provided with high-quality windows, with double or triple glazing, to ensure adequate thermal comfort and a reduction of costs.

LOW CONSUMPTION APPLIANCES: The chosen models have a high energy rating that ensures low consumption and significant cost savings.

Health & Well-being

This category is oriented to the comfort of the users from various perspectives: natural and artificial lighting, thermal and acoustic comfort, indoor air quality and safety.

NATURAL LIGHT: The design of the house allows the maximum use of natural light, improving the quality of life of the user and reducing the amount of artificial lighting.

TEMPERATURE: The temperature of each room can be regulated independently, adapting it to the consumer's desired use at any given moment.

Water

The client has at his disposal a smart meter that allows tracking water consumption in real-time.

DRIP IRRIGATION: The vegetation in the gardens has been chosen for its low water consumption.

LOW CONSUMPTION TAPS AND SHOWERS: The chosen faucets reduce drinking water consumption by up to 40%. In addition, the double push-button saves up to 3 liters of water each time the half-flush button is pressed.

Pollution

Pollution levels produced by construction are reduced:

EMISSIONS: lowering the level of greenhouse gas emissions and ozone depletion.

WATER STREAMS: contamination of the watercourses themselves caused by localized flooding at the site.

POLLUTION: reduction in light and noise pollution.

Materials

The materials used have a low environmental impact throughout the lifecycle of the building. Paints, varnishes and coatings with low levels of pollutants or VOCs (Volatile Organic Compounds) are used.

Transport

Alternatives are provided to improve people's mobility by offering options to replace private transport and encouraging walking and cycling projects.

Specific parking for bicycles.

Electric car charging points.

Proximity to public transport networks.

Proximity to usual facilities: supermarkets, health, education, cultural centers, sports, etc.

Land use and ecology

To maintain and enhance the site's ecological value before and after the construction is carried out.

The ecological value of the site is a priority and therefore measures have been taken to maintain the pre-existing flora and fauna.

The building has been constructed taking into account measures to prevent soil erosion caused by the construction site or by rainfall through the installation of slopes, specific plants to root the soil, etc.

Waste

There is efficient management of waste both from the construction site and from the operation of the building, thus reducing the amount of waste diverted to landfills.

Facilities are designed to facilitate recycling in a convenient and efficient way.

Transformation of organic waste into compost for the garden, thus reducing the volume of this waste and facilitating its use.

S U S T A I N A B L E



Our commitment
to sustainability &
culinary innovation is
the basis of our activity.

C U L T U R E

Making *living* sustainable.



Over the years our
aim has been to create
the perfect relationship
between architecture
and design, prioritising
respect for nature.

The privileged location
of this project offers a
home integrated with the
Mediterranean landscape, a
space surrounded by greenery,
fresh air and natural light that
improves the quality of life of
our clients.

Higuerón Resort has its own
aquaponics, an innovative
technique that combines fish
farming and plant cultivation
in an ecological way. The aim
is to produce fresher and more
nutritious food to continue
caring for our guests.

Inspired by a *topographical* plan, Valley Collection stands out for the sinuous movement of its Avant-grade architecture, which continues with the concept that characterizes the constructions of Higuierón Resort.

It is distinguished by the rich materials with which this project has been created. The combination of Wood, ceramic and aluminum achieves that warm touch that is so unique and exclusive.





Heaven of *nature*,

This Project is
constructed out of 224
houses.

South or south-west
facing, the flats are
very luminous and
allow you to enjoy
breathtaking sunsets
from your own terrace.

Heaven of *peace*.

Dreamy spaces



We have designed
this project in small
intimate buildings,
guaranteeing the
privacy of the
owners.



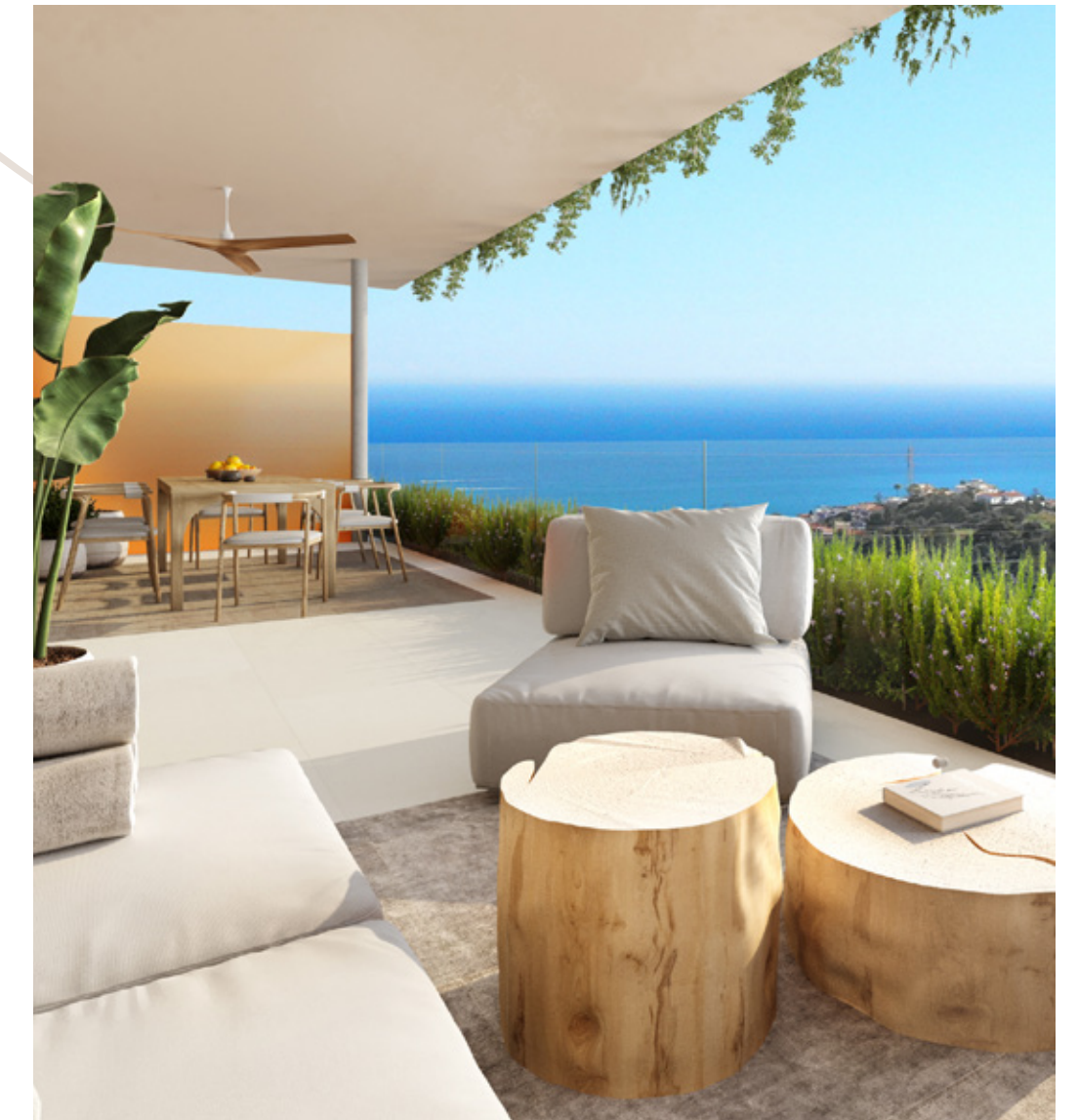

The properties are divided into Garden Villa, flats and penthouses; and are characterised by the large size of their rooms.

Design your home...



We furnish your home
with all the little details
for you to enjoy from
the very first moment.

We offer a completely
personalised service
to make you feel
comfortable at home.



Magical views



Each building is located on elevated platforms so that the horizon opens up at your feet and guarantees the best views the mediterranean sea can offer.





Garden villa

Interior built area Up to 117 m²
Outside area Up to 110 m²

Flats

Interior built area Up to 117 m²
Outside area Up to 23 m²

Penthouses

Interior built area Up to 130 m²
Outside area Up to 120 m²



Common areas *to enjoy*

Discover the essence of this project with over 20,000 square metres of Mediterranean vegetation and aromatic plants. Lose yourself in this paradise designed for nature lovers.

The 6 Swimming Pools distributed throughout the development allow you to enjoy magical moments with family and friends, creating unforgettable experiences.

Each house has two parking spaces and a storage room.

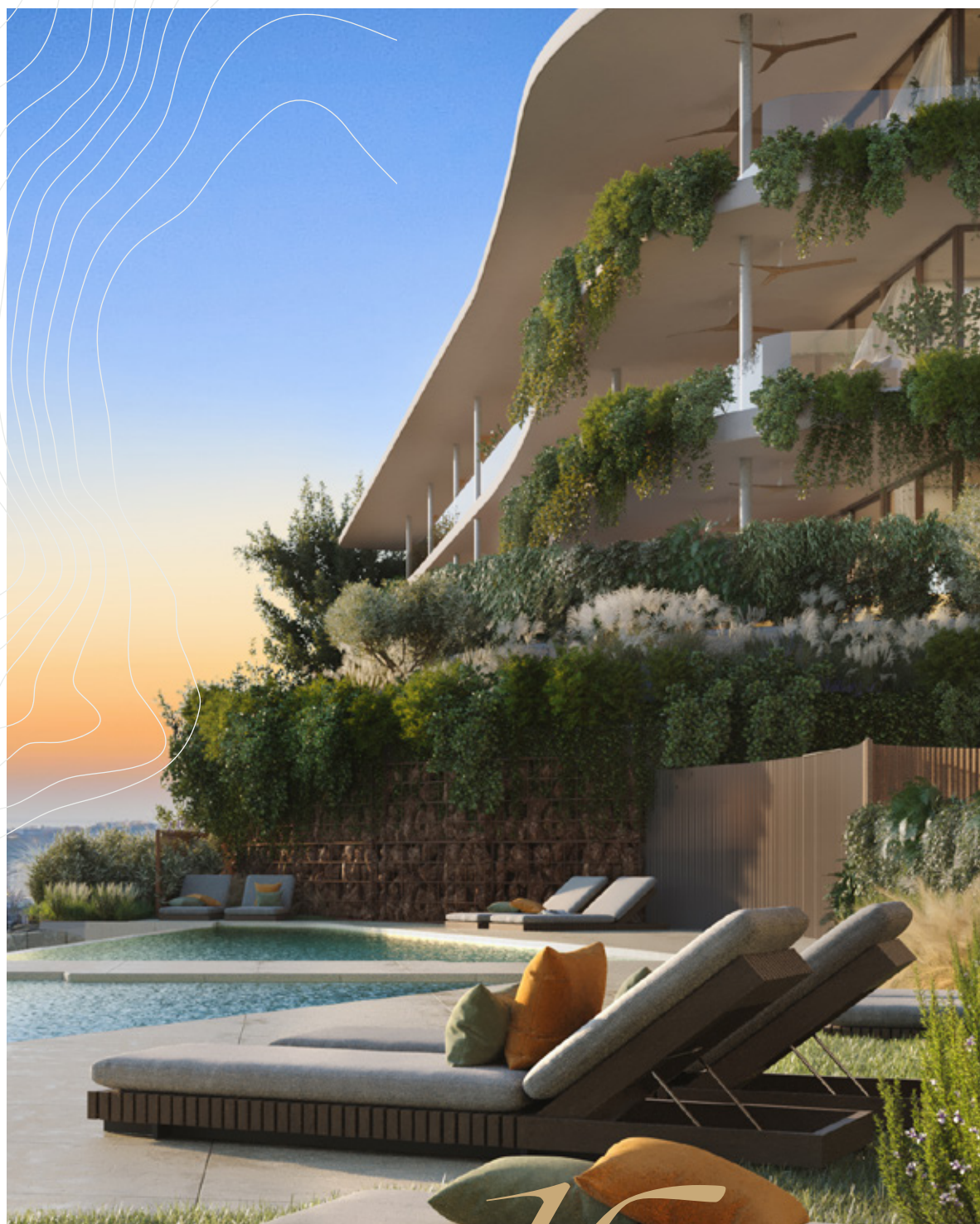

Valley

HIGUERÓN *Resort*
RESIDENCES & COLLECTIONS